

PERMIT

CITY OF NAPOLEON - BUILDING DEPARTMENT
 255 West Riverview Avenue, Napoleon, Ohio 43545 - 419-592-4010

Permit No. 150-78 Issued 9/5/78
date

Job Location 30 Lafayette Drive
address

Lot 51 Riviera Heights 1st Add'n.
sub-div or legal discript

Issued By *R.E. Johnson*
building official

Owner Edmund F. Rohrs XX
name tel.

Address 485 S. Wilhelm St. Holgate, Ohio

Agent Wolf-Rohrs Const. 264-5551
builder-eng.-etc. tel.

Address 101 Railway Ave.

Description of Use Single family dwelling

Residential XX(1)
no. dwelling units

Commercial _____ Industrial _____

New XX Add'n. _____ Alter _____ Remodel _____

Mixed Occupancy _____

Change of Occupancy _____

Estimated Cost \$ 40,000.00

FEES	BASE	PLUS	TOTAL
<input checked="" type="checkbox"/> BUILDING	\$69.00	-0-	\$69.00
<input checked="" type="checkbox"/> ELECTRICAL	5.00	\$29.00	34.00
<input checked="" type="checkbox"/> PLUMBING	3.00	10.00	13.00
<input checked="" type="checkbox"/> MECHANICAL	-0-	-0-	-0-
<input type="checkbox"/> DEMOLITION			
<input checked="" type="checkbox"/> ZONING	-0-	-0-	-0-
<input type="checkbox"/> SIGN			
W78-17 WATER TAP	225.00	-0-	225.00
S78-14 SEWER TAP	60.00	-0-	60.00
E78-14 TEMP. ELECT.	10.00	-0-	10.00
ADDITIONAL PLAN REVIEW	Struct. _____ hrs	Elect. _____ hrs	
TOTAL FEES.....			\$411.00
LESS MIN. FEES PAID _____			-0-
			<small>date</small>
BALANCE DUE.....			\$411.00

ZONING INFORMATION

district "A"	lot dimensions 79' x 125'	area 9,875sq'	front yd 25' OK	side yds 3.5' ea. OK	rear yd Min. 15' OK
max hgt 25' OK	no pkg spaces 2 OK	no ldg spaces n/a	max cover 35% OK	petition or appeal req'd -----	date appr ---

WORK INFORMATION:

Size: Length 62' Width 28' Stories Split-level Ground Floor Area 1,576sq'

Height ok Building Volume (for demo. permit) _____ cu. ft.

Electrical: 200 amp service & 29 circuits.
brief description

Plumbing: Water & DWV Lines.
brief description

Mechanical: Baseboard Electric heat 11 zone.
brief description

Sign: _____ Dimensions _____ Sign Area _____
type

Additional Information: CALL FOR INSPECTIONS MARKED ON ATTACHED SHEET: CERTIFICATE OF OCCUPANCY MUST BE ISSUED PRIOR TO BUILDING BEING OCCUPIED:

Date 9-7-78 Applicant Signature *Jerry E. Wolf*
owner-agent

INSPECTION RECORD

UNDERGROUND			ROUGH-IN						FINAL			
Type	Date	By	Type	Date	By	Type	Date	By	Type	Date	By	
PLUMBING	Building Drains		Drainage, Waste & Vent Piping	9/18/78	BDL	Indirect Waste			Drainage, Waste & Vent Piping			
	Water Piping								Backflow Prevention			
	Building Sewer	9/9/78	B.W.	Water Piping			Condensate Lines		Water Heater			
	Drainage & Vent	9/18/78	BDL									
	Sewer Connection	9/78	BDL						FINAL APPROVAL			
MECHANICAL	Refrigerant Piping		Refrigerant Piping			Chimney(s)			Grease Exhaust System			
			Duct Furnace(s)			Fire Dampers			Air Cond. Unit(s)			
	Ducts/Plenums		Ducts/Plenums			<input type="checkbox"/> Radiant Htr(s) <input type="checkbox"/> Unit Htr(s)			Refrigeration Equipment			
			Duct Insulation			Pool Heater			Furnace(s)			
			Combustion Products Vents			Ventilation <input type="checkbox"/> Supply <input type="checkbox"/> Exhst.			FINAL APPROVAL	1/19/79	BDL	
ELECTRICAL	Conduits & or Cable		Conduits/Cable			<input type="checkbox"/> Range <input type="checkbox"/> Dryer			Temp Service Temp Lighting			
	Grounding & or Bonding		Rough Wiring	10-4-78	N.H.	<input type="checkbox"/> Generator(s) <input type="checkbox"/> Motors			Fixtures Lampholders			
	Floor Ducts Raceways		Service Panel Switchboard	10-4-78	N.H.	<input type="checkbox"/> Water Htr <input type="checkbox"/> Welder			Signs			
	Service Conduit		Busways Ducts			<input type="checkbox"/> Heaters <input type="checkbox"/> Heat Cable			Electric Mtr. Clearance			
	Temporary Power Pole		Subpanels			<input type="checkbox"/> Duct Htr(s) <input type="checkbox"/> Furnace(s)			FINAL APPROVAL	1-18-78	N.H.	
BUILDING	Location, Set-backs, Esmt(s)		Exterior Wall Construction			Roof Covering Roof Drainage			Smoke Detector	1/19/79	BDL	
	Excavation					Exterior Lath			Demolition (sewer cap)			
	Footings & Reinforcing					<input type="checkbox"/> Interior Lath <input type="checkbox"/> Wallboard						
	Floor Slab		Interior Wall Construction			Fire Wall(s)			Building or Structure	1/18/78	BDL	
	Foundation Walls		Columns & Supports			Fireplace Chimney						
	Sub-soil Drain		Crawl Space <input type="checkbox"/> Vent <input type="checkbox"/> Access			Attic <input type="checkbox"/> Vent <input type="checkbox"/> Access						
	Piles		Floor System(s)						FINAL APPROVAL BLDG. DEPT.	1/19/79	BDL	
			Roof System			Special Insp Reports Rec'd			Certificate of #173 Occupancy Issued	" "	" "	
ADDITIONAL	INSPECTIONS, CORRECTIONS, ETC.						INSPECTIONS, CORRECTIONS, ETC.					
	Sec. R-215 RAILING & GUARDRAIL ON STAIRS											

RESIDENTIAL PLAN CORRECTION SHEET

CITY OF NAPOLEON, Building Dept.
 255 West Riverview Avenue
 Napoleon, Ohio 43545
 (419) 592-4010

ADDENDUM to Permit No. 150-78
Owner ROHRS
Location 30 LAFAYETTE DR.

Please note the Items checked below and incorporate them into your plans as indicated: Permit not yet issued
 Correct Plans and Re-Submit. Permit issued Incorporate the Items during construction.

GENERAL		
<input checked="" type="checkbox"/>	Provide 1 approved smoke detector.	Show size of members supporting porch roof.
<input checked="" type="checkbox"/>	Provide 1 hour fire wall and/or ceiling between garage and dwelling.	Provide double top plate.
<input checked="" type="checkbox"/>	Provide (Class B) 1 hour fire rated door from garage to dwelling.	Provide design data for pre-fab. wood truss/members.
	Submit fully dimensioned plot plan.	Ceiling joists undersized in.....
	Provide 1-3'0" x 6'8" exit door.
	Provide min. 22" x 30" attic access.	Roof rafters undersized in.....
	Provide min. 18" x 24" crawl space access opening.
	LIGHT AND VENTILATION:	PLUMBING AND MECHANICAL:
	Provide mechanical exhaust or window in bathroom.....	<input checked="" type="checkbox"/> Terminate all exhaust systems to outside air.
<input checked="" type="checkbox"/>	Provide Min. <u>726</u> sq. in. net free area attic ventilation.	Insulate ducts in unheated areas.
	Provide min. _____ sq. in. net free area crawl space ventilation.	Provide back flow device on all hose bibs.
	FOUNDATION:	ELECTRICAL:
	Min. depth of foundation below finished grade 30".	Show location of service entrance and service equipment panel.
	Min. size of footer....." x"	<input checked="" type="checkbox"/> G.F.C.I. req'd. on Temp. Electric.
	Provide anchor bolts 1/2" @ 8' o.c. 1' from each corner. Embedded 8" concrete and 15" in masonry.	<input checked="" type="checkbox"/> Outdoor and bathroom receptacles shall be protected by G.F.C.I. <u>5 GARAGE</u>
	Show size of basement columns.	METAL VENEERS:
	FRAMING:	Contact City Utilities Dept. to remove conductors and/or meter.
	Show size of wood girder in.....	Provide 18" x 18" x 3/4" wood backer for meter base.
	Provide design data for structural member in.....	Provide approved system of grounding and bonding.
	Floor joists under sized in.....	MISCELLANEOUS:
	Provide double joists under parallel partitions.	Provide backwater valve in sub-soil drain tile.
	Provide 1" x 4" let in corner bracing or approved sheathing.	Provide approved sheathing and flashing behind masonry veneer.
	Show size of headers for openings over 4' wide.	Provide 15# felt underlayment on roof.
		Provide adequate fireplace hearth extensions
		Install factory built fireplaces/stoves according to manufacturers recommendations.
		Terminate chimney 3' above roof or 2' above highest point of building within 10' of chimney.

ADDITIONAL CORRECTIONS: _____

The approval of plans and specifications does not permit the violation of any section of the Building Code, or other City Ordinance or State Law. This addendum is attached to Permit No. 150-78 and made a part thereof.

Date Approved or Disapproved 9-5-78

Checked By L. Sonnenberg
 Plan Examiner

Date Rechecked and Approved _____

Checked By _____

CITY OF NAPOLEON
ENGINEERING DEPARTMENT
APPLICATION FOR CONSTRUCTION PERMIT
(PLEASE PRINT OR TYPE)

150-78
69.00

The undersigned hereby makes application for the construction, installation, replacement or alteration as herein specified, agreeing to do all such work in strict accordance with the City of Napoleon's Building Code for 1, 2 and 3 Family Buildings.

Owner's Name Edmund F. Rohrs Address 485 S. Wilhelm, Holgate, OH

Builder's Name Wolf-Rohrs Const. Address 101 Railway Ave. Holgate, Ohio Tel. 264-5551

LOT INFORMATION: (Not required for roofing or siding job.)

Location of Project ³⁰ Lafayette Dr., Napoleon, OH Lot # 51

Subdivision Riviera Heights Lot Area 9875 Sq. Ft.

Yard Set Back: Front 25' Rear _____ Left Side 8 1/2'

Right Side 8 1/2' Zoning District _____

BUILDING INFORMATION:

Single yes ^{family} Double _____ Multiple _____ New Construction yes

Addition _____ Remodel _____ Attached Garage yes

Detached Garage _____ Accessory Building _____ Replacement _____

Brief Description of Work: Split-level

Size: Length 62' Width 28' No. of Stories _____

Floor Area: upper level 1st Floor 616 Sq. Ft. middle level 2nd Floor 462 Sq. Ft.

lower level 3rd Floor 540 Sq. Ft. Basement _____ Sq. Ft.

Unfinished Attic _____ Garage 486 sq. ft.

Foundation: Piers _____ Full Basement _____ Part Basement yes Total living area 1,618.

Concrete yes 8" wall thickness Block _____ Size _____

Walls: Frame 2x4x16 block _____ Brick _____ Other _____

Specific Type of Exterior Siding Brick & vinyl

APPLICATION FOR PERMIT SHALL BE ACCOMPANIED BY TWO COMPLETE SETS OF PLANS INCLUDING: ELEVATIONS, FLOOR PLANS, CROSS SECTIONS AND PLOT PLAN. IF ADDITIONS OR REMODELING, SHOW ALL EXISTING STRUCTURES AND THEIR SIZE AND LOCATION. ALL PLANS SHALL BE DRAWN TO 1/4"=1'-0" SCALE. PLOT PLAN DRAWN TO 1/8"=1'-0" SCALE.

ESTIMATED COST OF COMPLETED PROJECT: Forty Thousand Dollars (40,000.00)

DATE July 25, 1978 APPLICANT'S SIGNATURE Jerry E. Wolf

OWNER-BUILDER-AGENT

CITY OF NAPOLEON
BUILDING INSPECTION DEPARTMENT
APPLICATION FOR ELECTRICAL PERMIT
(PLEASE PRINT OR TYPE)

5/29/78

The undersigned hereby makes application for the installation, replacement, or alteration of electrical equipment as herein specified, agreeing to do all such work in strict accordance with the City of Napoleon's adopted Electrical Code for 1, 2 and 3 Family Buildings.

Owner's Name Edmund F. Rohrs Address 485 S. Wilhelm St. Holgate Ohio

Contractor's Name Wolf-Rohrs Const. Address 101 Railway Ave. Holgate, OH 43527 Tel. 264-5551

LOT INFORMATION:

Location of Project Lafayette Dr., Napoleon, OH Zoning District _____

BUILDING INFORMATION:

Single Family X Double Family _____ Multiple Family _____

New Construction X Existing _____ Addition _____

Replacement _____ Remodel _____ Service Change _____

Size: Total Square Foot Per Floor upper level 610 No. of Stories Split-level
540 lower level, 462 middle level. ~~610~~ Total living area-----1,618.

DESCRIPTION OF WORK

Size of Service 200 AMP. Service Change Only Yes (Yes or No)

Total Number of New Circuits 29 Total Number of New Circuits Excluding Appliance Circuits 23

APPLIANCE CIRCUITS: (indicate quantity)

Electric Range 1 Range Hood 1 Clothes Dryer 1 Dishwasher 0

Air Conditioner 0 Attic Fan Blower 0 Room Exhaust Fan 2

Disposal 0 Hot Water Heater 1 Electric Oven 0

Require Temporary Electric Yes (Yes or No)

Note: G.F.I.C. required for all temporary electric with approved ground rod at service.

APPLICATION FOR PERMIT SHALL BE ACCOMPANIED BY TWO COMPLETE SETS OF PLANS INCLUDING: ELECTRICAL LAY-OUT AND RISER DIAGRAM.

ESTIMATED COST OF COMPLETED PROJECT: \$ 2500.00

DATE August 29, 1978 APPLICANT'S SIGNATURE _____

Jerry E. Wolf
OWNER CONTRACTOR-AGENT

CITY OF NAPOLEON
 BUILDING INSPECTION DEPARTMENT
 APPLICATION FOR PLUMBING PERMIT
 (PLEASE PRINT OR TYPE)

3
10
/13

The undersigned hereby makes application for the installation, replacement or alteration of plumbing system or device as herein specified, agreeing to do all such work in strict accordance with the City of Napoleon's adopted Plumbing Code for 1, 2 and 3 Family Buildings.

Owner's Name Edmund F. Rohrs Address 485 S. Wilhelm St. Holgate, OH

Contractor's Name Wolf-Rohrs Const. Address 101 Railway Ave. Holgate, OH 43527 Tel. 264-5551

BUILDING INFORMATION:

Single Family Double Family _____ Multiple Family _____ New Construction

Addition _____ Remodel _____ Replacement _____ No. of Stories Split-level

DESCRIPTION OF WORK

Drainage Pipe Of: Cast Iron _____ Copper _____ Other PVC

Size of Main Building Drain: 4" PVC Other P

Size of Main Vent Stack: 3" PVC 4" Other _____

Require Water Tap: Yes (Yes or No) Require Sewer Tap: Yes (Yes or No)

Size and Type of Water Tap 3/4" copper

Size and Type of Sewer Tap 6" premium joint Type of Joints premium

No. of Water Closets	<u>3</u>	No. of Sump Pumps	<u>1</u>
No. of Bathtubs	<u>2</u>	No. of Lavatories	<u>3</u>
No. of Kitchen Sinks	<u>1</u>	No. of Automatic Washers	<u>1</u>
No. of Disposals	<u>0</u>	No. of Hot Water Heaters	<u>1</u>
No. of Dishwashers	<u>0</u>	No. of Shower Receptors	<u>0</u>
No. of Floor Drains	<u>0</u>	Other (Specify) <u>None</u>	<u>--</u>

Storm Drainage Outlet to: Storm Sewer Yes Other 4" tile

APPLICATION FOR PERMIT SHALL BE ACCOMPANIED BY TWO COMPLETE SETS OF A DRAINAGE ISOMETRIC, WITH ALL PIPES AND TRAPS PROPERLY SIZED. MUST INDICATE TOTAL DRAINAGE FIXTURE UNIT VALUE (dfu).

ESTIMATED COST OF COMPLETED PROJECT: \$ 2,500.00

DATE August 29, 1978 APPLICANT'S SIGNATURE Jerry E. Wolf
 OWNER-CONTRACTOR-AGENT

0 in Elect.

The undersigned hereby make application for the installation, replacement or alteration of a heating system or device as herein specified, agreeing to do all such work in strict accordance with the City of Napoleon's adopted Mechanical Code for Single Family Buildings

Owner's Name Edmund F. Rohrs Address 485 S. Wilhelm St. Holgate OH

Contractor's Name Wolf-Rohrs Construction Address 101 Railway Ave. Holgate, Ohio 43527 Tel. 264-5551

BUILDING INFORMATION:

Single Family Double Family _____ Multiple _____ New Construction

Addition _____ Renovation _____ Replacement _____ No. of Stories Split-level

DESCRIPTION OF WORK

Heating System - Warm Air _____ Hot Water _____ Steam _____ Electric
Baseboard

Unit Heaters _____ Only One Heater _____ Other _____

Type - Gravity _____ Forced _____ Radiant _____

No. of Thermostatical Control Units 11

Hot Water - One Pipe _____ Two Pipes _____ Series Loop _____

Electric Heat - No. of Circuits 6 Other _____

Total Heat Load of Area to be Heated _____ Btu.

Rated Capacity of Furnace/Boiler _____ Btu.

No. of Furnaces _____ No. of Hot Air Runs _____

No. of Hot Water Radiators _____ Type of Fuel _____

Heating Units Located: Crawl Space _____ Floor Level Suspended _____

Roof or Exposed to Outside Air _____ Attic _____ Other _____

APPLICATION FOR PERMIT SHALL BE ACCOMPANIED BY TWO COMPLETE SETS OF PLANS INCLUDING: LOCATION OF FURNACE OR UNIT HEATERS AND SIZE AND LOCATION OF FEEDER DUCTS AND RETURN AIR DUCTS. ALL PLANS SHALL BE DRAWN TO SCALE

ESTIMATED COST OF COMPLETED PROJECT _____

DATE August 29, 1978

APPLICANT'S SIGNATURE

Jerry E. Wolf

OWNER-CONTRACTOR-AGENT

Date: 9-5-78

Division Superintendent
Building Inspector - Building Department

proposed installation of 3/4" COPPER water tap
OF PROPOSED HOUSE

Address: 30 LAFAYETTE DR.

Lot # 51

Not Approved

Sept 5
Date

6" A.C. main stop left

APPLICATION FOR PERMIT TO TAP SEWER

(Print or Type)

Owner EDMUND F. ROHRS
Address 485 S. Wilhelm St. Holgate, Ohio
Contractor Wolf-Rohrs Const.
Address 101 Railway Ave. Holgate, Ohio Tel. 26495551

NO. S78-14
BLDG. PERMIT 150-78
PERMIT FEE \$ 60.00
DATE PAID 9-7-78
for office use only

LOCATION OF CONNECTION

Street and No. 30 Lafayette Dr. Sanitary XXX Storm _____
Lot No. 51 Subdivision Riviera Heights 1st Add'n. Size of Tap 6"
Size and Type of Sewer 6" Pre. Joint.

ALL WORK MUST BE INSPECTED

I certify that the sewer will be used only as indicated and no other Drainage will be connected.

Date _____ Signature _____
owner-builder-agent
do not write below this line

INSPECTION RECORD

Date Inspected 11-9-78 Size and Type of Sewer 4" MC CLAY
Location FRONT OF USE Depth 8' @ TAP Type of Test NONE
Inspected and Approved By: Bruce Whianch Date 11-9-78
Additional Information _____ Inspector _____ Date _____

Send copy to: WOLF-ROHRS.

SKETCH OF INSTALLATION

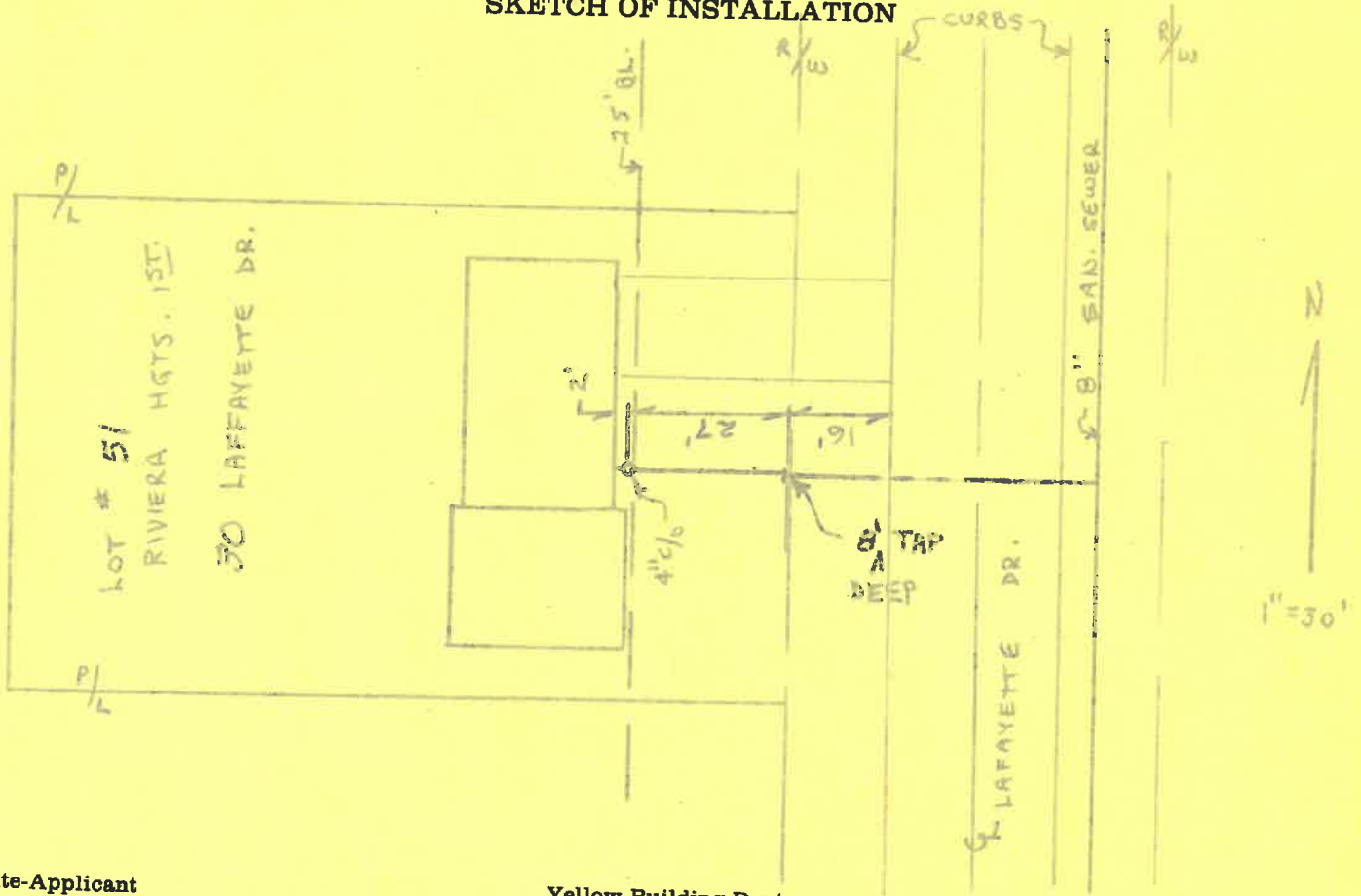

White-Applicant

Yellow-Building Dept.

Pink-Clerk-Treasurer

No. ...173.....

CERTIFICATE OF OCCUPANCY
THE CITY OF NAPOLEON

ENGINEERING DEPARTMENT
DIVISION OF INSPECTION

This is to certify that the Building or Land as herein described complies with all the building and health laws and ordinances and with the provisions of the Zoning Ordinance.

Location of Occupancy 30 Lafayette Occupancy Single Family Dwelling
Owner of Property Edmund F. Rohrs Address 485 S. Wilhelm
Holgate, Ohio
Issued to Wolf-Rohrs Construction Address 101 Railway Ave.
Holgate, Ohio
Zoning "A" Residence District Bldg. Permit No. 150-78

Substantial qualifications of occupancy

This certificate is issued by the City Building Inspector, as provided by law, and is to certify that construction is completed substantially in conformity with the approved plans and permission is hereby granted to occupy such building in compliance with such legal use and occupancy as authorized under the provisions of the ordinances of the City of Napoleon.

Issued this 22nd day of January 1979

This is a valuable record for owner or lessee and should be so preserved.

Signed *Ronald D. Schamberger*
Asst. City Building Inspector

30 Lafayette

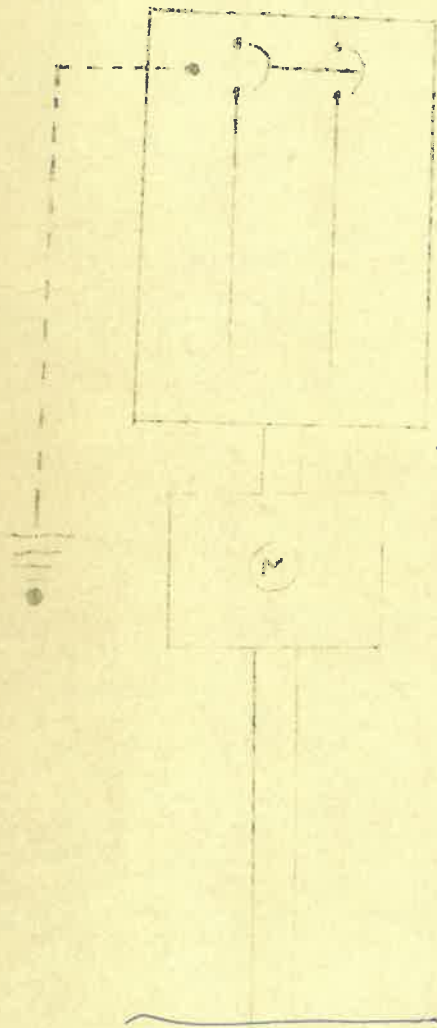

SERVICE EQUIPMENT
MAIN 120/240V 1 Ø 3 Wire
BRANCH CIRCS TOTAL

3/0 Wire
2" Conduit

Conduit

Ground

SERVICE BY POWER COMPANY

